

1 | ESTRUTURA REGULAR | MODULAR



2 | CIRCULACAO + INFRAESTRUTURA



3 | PROGRAMAS FLEXIVEIS

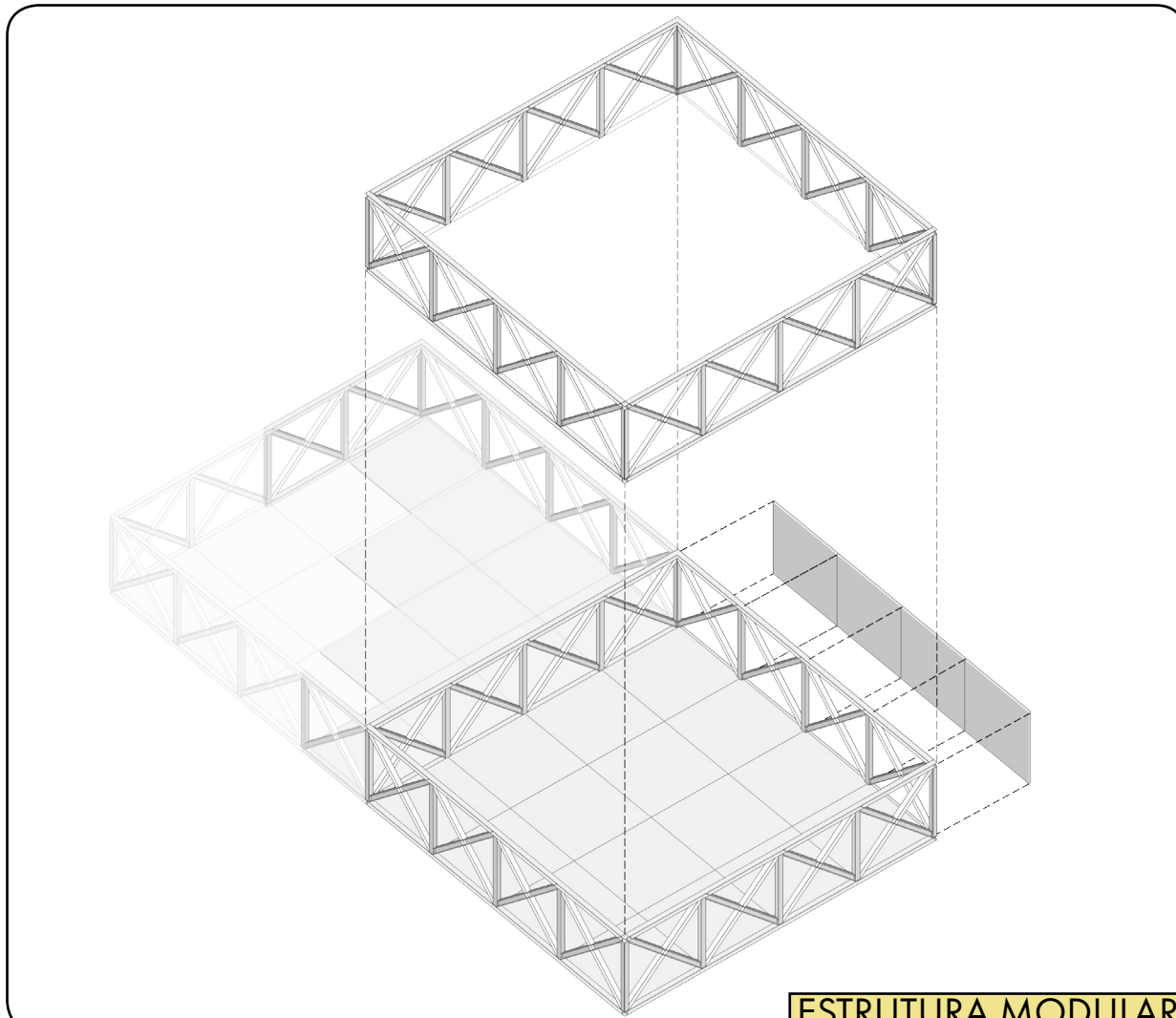

ESTRUTURA MODULAR

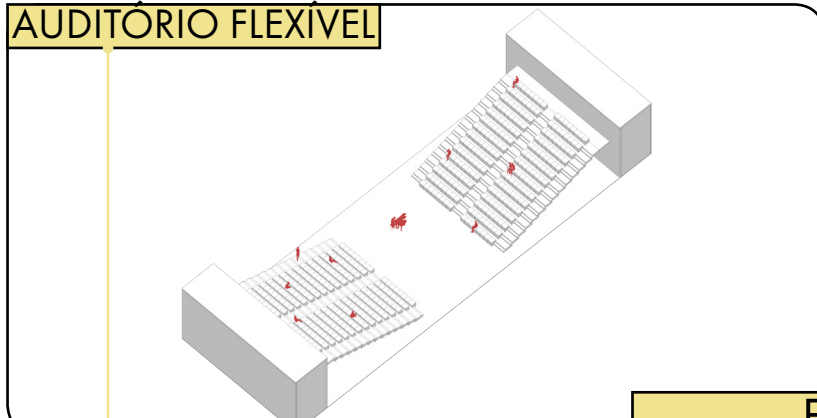

AUDITÓRIO FLEXÍVEL

Eventos 480 pessoas

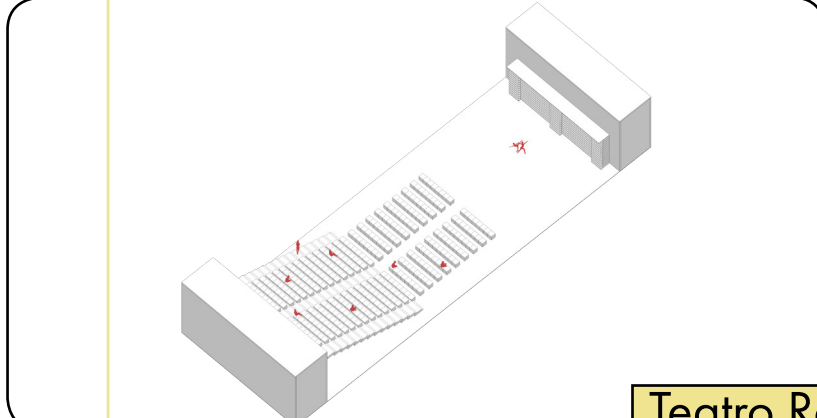

Teatro Romano 480 pessoas

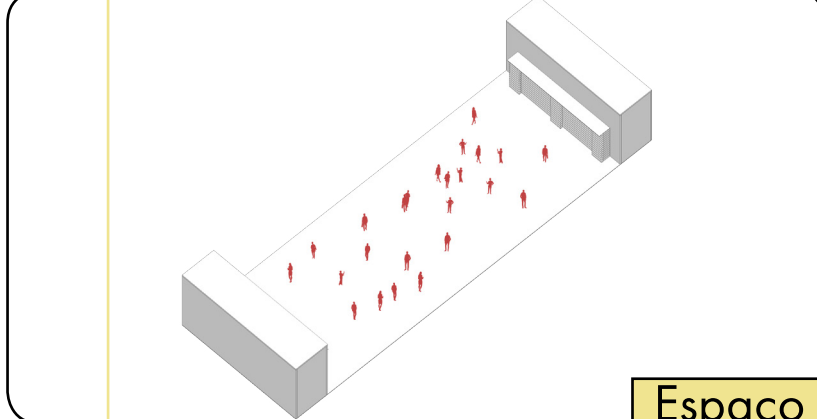

Espaço Aberto 350 pessoas

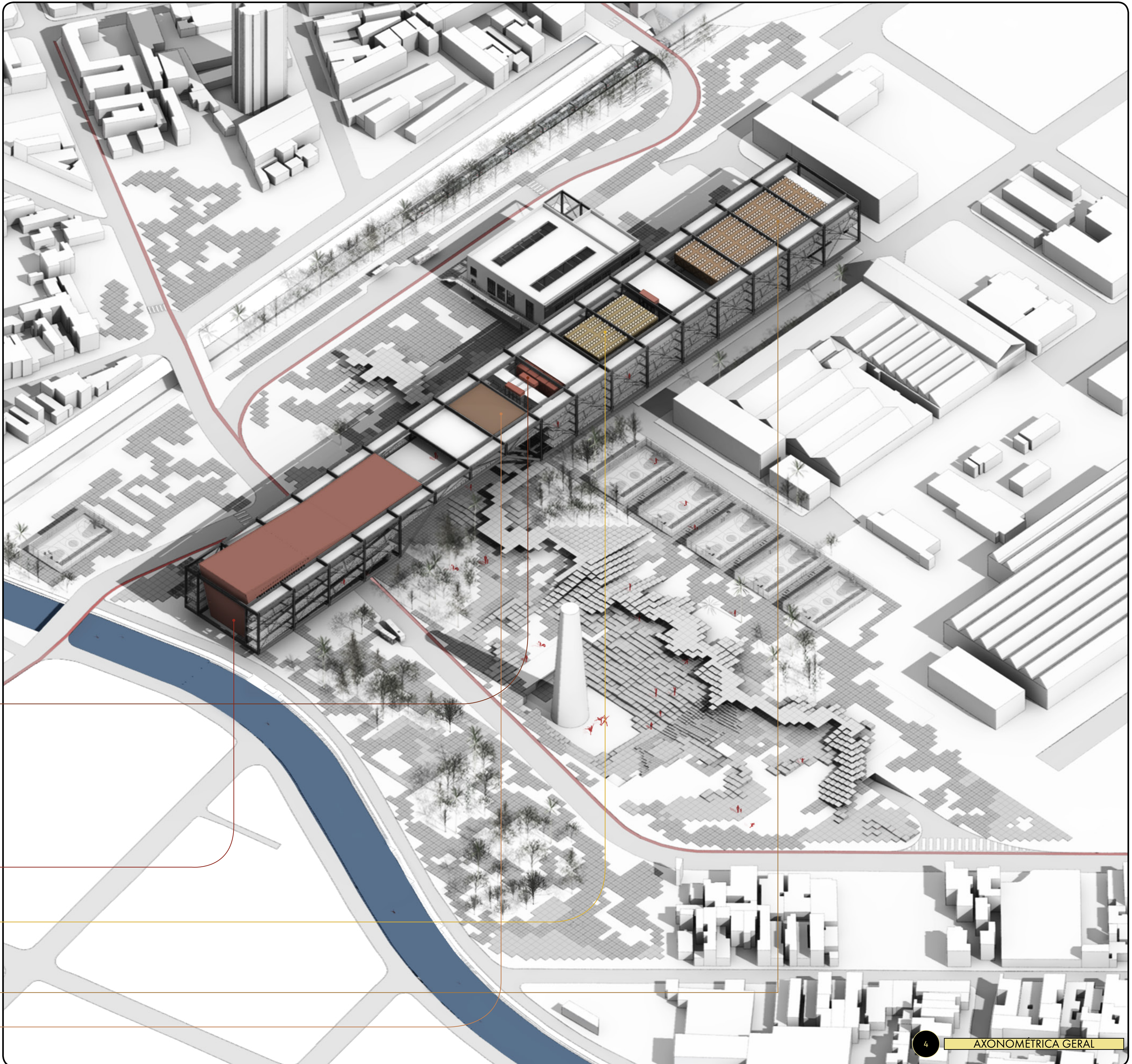
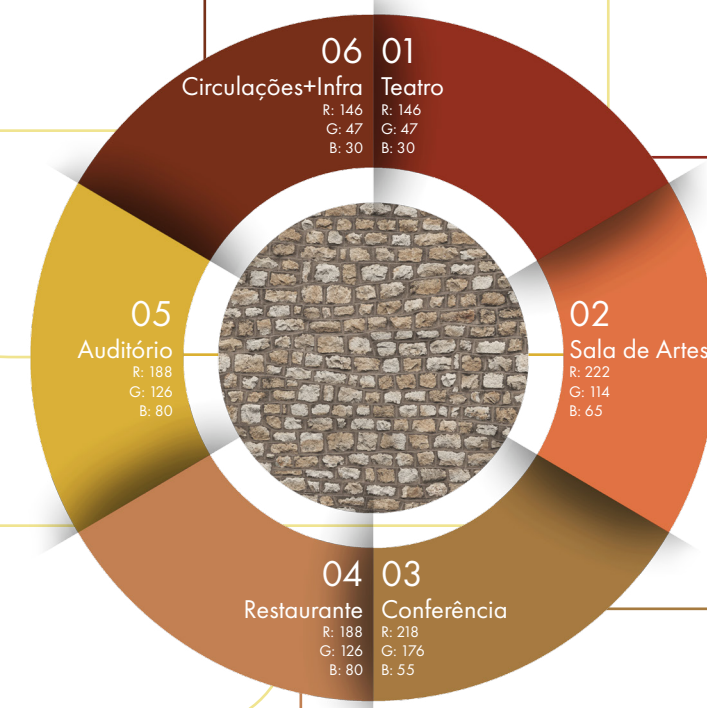

4 | AXONOMÉTRICA GERAL

